

## Insert battery / SD card

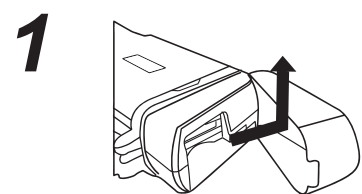

1 Check if the power is off and slide the battery cover in the direction of the arrow.

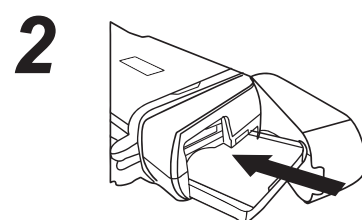

2 Insert the battery pack. Insert the battery in the direction of the arrow.

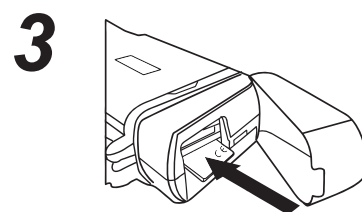

3 Insert the SD card. Insert the SD card in the direction of the arrow.

4 Close the battery cover / SD card cap.

## Turning the power On / Off

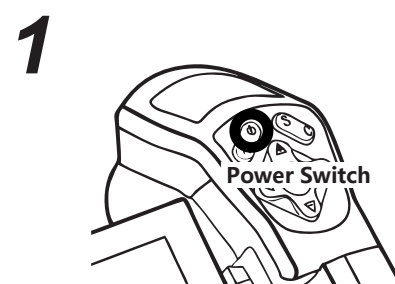

1 Press and hold the power switch for 3 seconds. The power indicator lights green.

2 Turn off the camera. Hold the power switch for 3 seconds, the power indicator goes off.

Note: the power indicator will keep lighting when camera is powered on.

## Using the LCD monitor

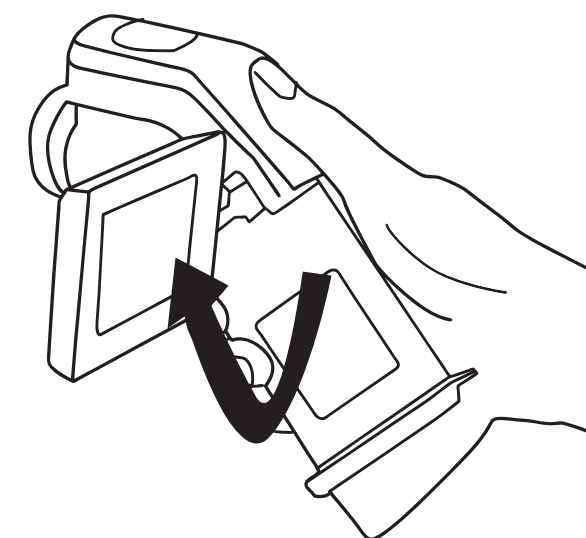

Open the LCD displayer in the direction of the arrow.

## Manually Focus

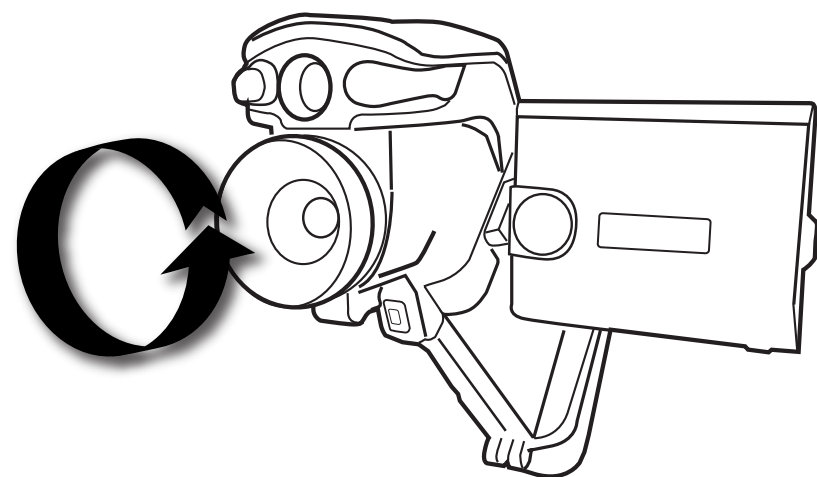

Aim the IR camera at the subject, turn the focus ring to focus on the target.

## Resetting the settings to Default

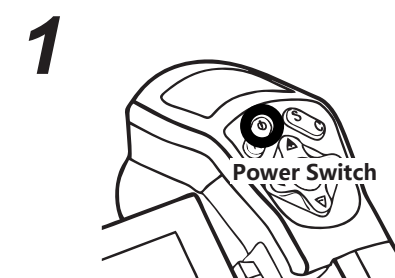

1 Turn off the IR camera.

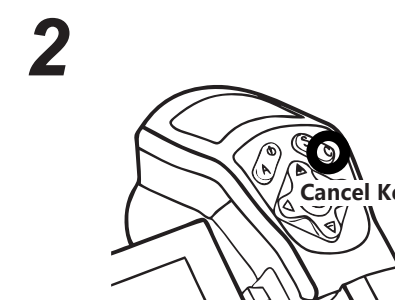

2 Press and hold the power switch and C key for seconds.

## Charge the battery

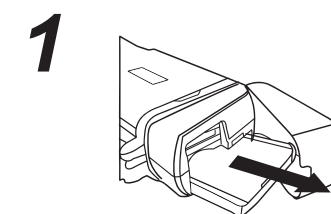

1 Take out the battery.

2 Attach the power cord to the battery charger.

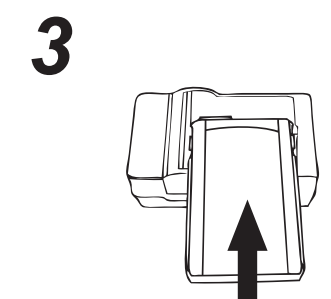

3 Align the edge of the battery then insert it.